



CANAL TOYS
AIRBRUSH PLUSH - MEDIUM
OPG 266 - FOB 1
INSTRUCTION SHEET
A3 - L 297 x H 420 mm - 4C PRINTING - 2 SIDED



Content - Contenu - Contenido
Contants - Inhalt - Soddifare

1 FLUOR PUMP - PULSADA - PULSADA
 1 AIRBRUSH COLOURS - VERFEN - VERFEN
 1 STICK-ON STENCILS - STICKER - STICKER

1 FLUOR PUMP - PULSADA - PULSADA
1 AIRBRUSH COLOURS - VERFEN - VERFEN
1 STICK-ON STENCILS - STICKER - STICKER



IMPORTANT TIPS

1. Always use the correct nozzle for the pump. Replace the nozzle for the next size when you are done with the current pump.

2. If the nozzle is not working properly, clean it with water and a soft brush.

3. If the pump is not working properly, clean it with water and a soft brush.

4. If the pump is not working properly, clean it with water and a soft brush.

5. If the pump is not working properly, clean it with water and a soft brush.

FRONT

ENGLISH

Prepare your work space by putting down some newspaper or cardboard to protect your table.
 Prepare your work space by putting down some newspaper or cardboard to protect your table.
 Prepare your work space by putting down some newspaper or cardboard to protect your table.

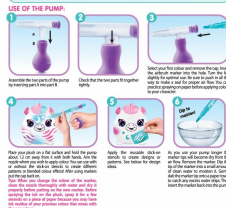

FRANCAIS

Préparez le zone de travail en posant du papier journal ou du carton pour protéger le table.
 Préparez le zone de travail en posant du papier journal ou du carton pour protéger le table.
 Préparez le zone de travail en posant du papier journal ou du carton pour protéger le table.



ESPAÑOL

Prepara tu zona de trabajo poniendo algún periódico o cartón para proteger tu mesa. Lo tita de...
 Prepara tu zona de trabajo poniendo algún periódico o cartón para proteger tu mesa. Lo tita de...
 Prepara tu zona de trabajo poniendo algún periódico o cartón para proteger tu mesa. Lo tita de...



DIYING IMPORTANT

Do not use the pump to spray anything other than the paint. The pump is not designed to spray anything else.



SECAGE IMPORTANT

Do not touch the painted surface until it is completely dry. It may take several hours to dry.



LA LIMPEZA

Always clean the pump after use. Use water and a soft brush to clean the pump.



USING STICK-ON STENCILS

Place the stencil on the surface you want to paint. Use the pump to spray paint through the stencil.



UTILISATION DES POCHES

Place the stencil on the surface you want to paint. Use the pump to spray paint through the stencil.



USO DE LAS PLANTILLAS

Place the stencil on the surface you want to paint. Use the pump to spray paint through the stencil.



CONSEILS IMPORTANTS

1. Always use the correct nozzle for the pump. Replace the nozzle for the next size when you are done with the current pump.

2. If the nozzle is not working properly, clean it with water and a soft brush.

3. If the pump is not working properly, clean it with water and a soft brush.

4. If the pump is not working properly, clean it with water and a soft brush.

5. If the pump is not working properly, clean it with water and a soft brush.

CONSEJOS IMPORTANTES

1. Siempre usar la boquilla correcta para la bomba. Cambiar la boquilla por la siguiente cuando se termine con la actual.

2. Si la boquilla no funciona correctamente, límpiala con agua y un cepillo suave.

3. Si la bomba no funciona correctamente, límpiala con agua y un cepillo suave.

4. Si la bomba no funciona correctamente, límpiala con agua y un cepillo suave.

5. Si la bomba no funciona correctamente, límpiala con agua y un cepillo suave.

CONSIGLI IMPORTANTI

1. Usare sempre la sonda corretta per la pompa. Sostituire la sonda per la successiva quando si è finito con quella attuale.

2. Se la sonda non funziona correttamente, puliscila con acqua e un pennello morbido.

3. Se la pompa non funziona correttamente, puliscila con acqua e un pennello morbido.

4. Se la pompa non funziona correttamente, puliscila con acqua e un pennello morbido.

5. Se la pompa non funziona correttamente, puliscila con acqua e un pennello morbido.

BACK

PORTUGUÊS

Prepara o seu espaço de trabalho colocando algum jornal ou cartão para proteger a sua mesa. O tita de...
 Prepara o seu espaço de trabalho colocando algum jornal ou cartão para proteger a sua mesa. O tita de...
 Prepara o seu espaço de trabalho colocando algum jornal ou cartão para proteger a sua mesa. O tita de...



DEUTSCH

Bereite deinen Arbeitsbereich vor, indem du Zeitung oder Karton auf dein Tisch legst. Das tita de...
 Bereite deinen Arbeitsbereich vor, indem du Zeitung oder Karton auf dein Tisch legst. Das tita de...
 Bereite deinen Arbeitsbereich vor, indem du Zeitung oder Karton auf dein Tisch legst. Das tita de...



DUTCH

Bereid je werkruimte voor door wat kranten of karton op je tafel te leggen om te beschermen. Het tita de...
 Bereid je werkruimte voor door wat kranten of karton op je tafel te leggen om te beschermen. Het tita de...
 Bereid je werkruimte voor door wat kranten of karton op je tafel te leggen om te beschermen. Het tita de...



ITALIANO

Prepara la tua zona di lavoro coprendo con qualche giornale o cartone da mettere a protezione il tavolo. Lo tita de...
 Prepara la tua zona di lavoro coprendo con qualche giornale o cartone da mettere a protezione il tavolo. Lo tita de...
 Prepara la tua zona di lavoro coprendo con qualche giornale o cartone da mettere a protezione il tavolo. Lo tita de...



SECAGE IMPORTANT

Do not touch the painted surface until it is completely dry. It may take several hours to dry.



LA LIMPEZA

Always clean the pump after use. Use water and a soft brush to clean the pump.



USANDO LOS ESTENCILS

Place the stencil on the surface you want to paint. Use the pump to spray paint through the stencil.



UTILIZANDO LOS ESTENCILS

Place the stencil on the surface you want to paint. Use the pump to spray paint through the stencil.



USANDO LOS ESTENCILS

Place the stencil on the surface you want to paint. Use the pump to spray paint through the stencil.



USANDO LOS ESTENCILS

Place the stencil on the surface you want to paint. Use the pump to spray paint through the stencil.



CANAL TOYS

2023
 100% POLYURETHANE
 100% POLYURETHANE
 100% POLYURETHANE

CE UK CA

ATTENZIONE: NON USARE LA POMPA PER SPRAYARE ALTRE COSE O PER SPRAYARE IN UN'ALTRA MANIERA. LA POMPA È DESTINATA SOLO ALL'USO PER IL QUALE È STATA PROGETTATA. L'USO INALTRAMODO PUÒ CAUSARE DANNI ALLA POMPA O AGLI OGGETTI SPRAYATI. LEGGERE ATTENTAMENTE LE ISTRUZIONI PRIMA DI USARE LA POMPA.