

ARMARIO

Roupeiro
Armoire
Wardrobe

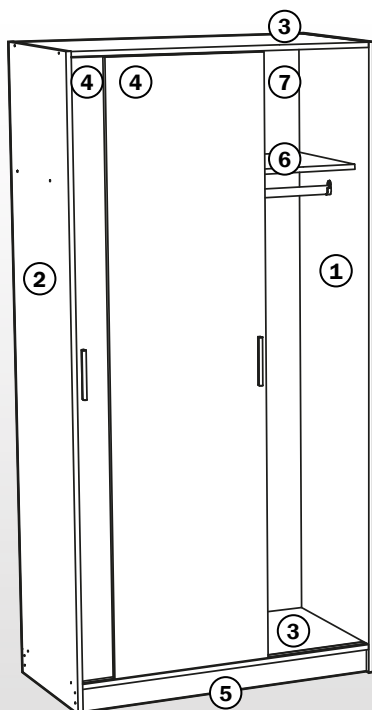

K-511

Alto: 2000mm

Altura - Height - Hauteur

Ancho: 1000mm

Largura - Width - Largeur

Fondo: 500mm

Profundidade - Depth - Profondeur

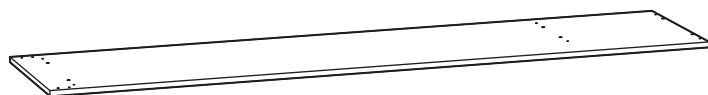

1 Costado Derecho 2000x500x16

Lateral Derecho - Right Side - Côté Droit

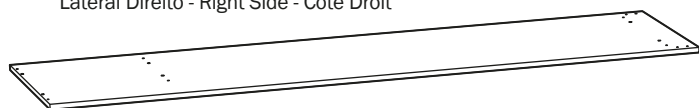

2 Costado Izquierdo 2000x500x16

Lateral Esquerdo - Left Side - Côte Gauche



3 Techo/Fondo 968x499x16

Superior/Inferior - Top/Bottom - Troit/Tablette du Bas

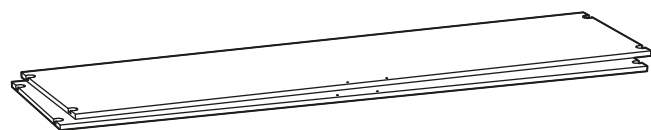

4 Puerta 1887x500x16

Porta - Door - Porte



5 Zocalo / Barra 968x76x16

Rodapé/Barra - Skirting Board/Bar - Plinthe/Barre



6 Estante Fijo 968x404x16

Prateleira Fixa - Fixed Shelf - Étagère Fixe

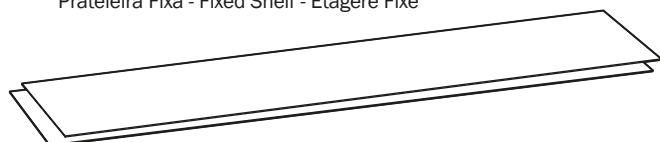

7 Trasera 1923x499x3

Painel Traseiro - Back Panel - Panneau D'Arrière

sac@meka-block.com

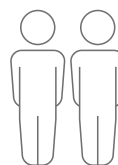
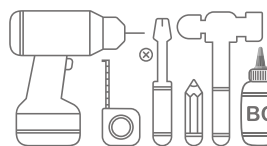
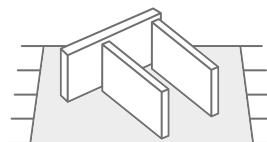

ES. No ingerir. Agitar antes de usar.

PT. Não ingerir. Agite antes de usar.

EN. Do not swallow. Shake before use.

FR. Ne pas ingérer. Agiter avant utilisation.

ES. Montaje del mueble sobre una superficie de protección.

PT. Monte os móveis em uma superfície protetora.

EN. Mount the furniture on a protective surface.

FR. Montez le meuble sur une surface de protection.

ES. Material necesario para el montaje del mueble.

PT. Material para o qual você deve usar montagem.

EN. Material that you have to use for assembly.

FR. Matériel que vous devez utiliser pour l'assemblage.

ES. Algunos pasos del montaje requieren de dos personas para su correcta realización.

PT. Alguns etapas exigem 2 pessoas para sua montagem.

EN. Some assembly steps require two people.

FR. Certaines étapes d'assemblage nécessitent deux personnes.

ES. El montaje del mueble deberá realizarse siguiendo las instrucciones del fabricante, en caso contrario, puede haber riesgo de seguridad por caída o vuelco. Podría provocar lesiones graves.

Siga las siguientes instrucciones de seguridad:

- Evite poner objetos pesados sobre el producto.

- Evite que los niños se apoyen en los cajones o estantes.

- Coloque los objetos más pesados en la parte inferior del mueble.

- Fije el mueble a la pared. En caso contrario puede haber riesgo de seguridad por caída o vuelco que pueden provocar lesiones graves.

Como existen diferentes materiales de pared, no se incluyen los tornillos de montaje ni tacos que anclarán a esta parte. Para encontrar el sistema de sujeción adecuado a su pared póngase en contacto con su especialista más cercano.

PT. Os móveis devem ser montados de acordo com as instruções do fabricante, caso contrário pode haver perigo de queda ou tombamento. Isto pode resultar em ferimentos graves.

As instruções de segurança devem ser seguidas:

- Evitar colocar objectos pesados sobre o mobiliário.

- Evitar que as crianças se inclinem ou trepem em gavetas ou prateleiras.

- Colocar os objectos mais pesados sobre o fundo do mobiliário.

- Fixar o móvel à parede. Caso contrário, pode haver um risco de segurança devido a queda ou tombamento, o que pode causar ferimentos graves.

Como existem diferentes materiais de parede disponíveis, os parafusos de montagem e os tampões de parede que irão ancorar esta parte não estão incluídos. Para encontrar o sistema de fixação correcto para a sua parede, por favor contacte o especialista mais próximo.

EN. The furniture must be assembled in accordance with the manufacturer's instructions, otherwise there may be a safety danger of falling or tipping over. This could result in serious injury.

Safety instructions must be followed:

- Avoid placing heavy objects on the furniture.

- Prevent children from leaning or climbing on drawers or shelves.

- Place the heaviest objects on the bottom of the furniture.

- Secure the cabinet to the wall. Otherwise, there may be a safety risk due to falling or tipping over, which can cause serious injuries.

As there are different wall materials available, the mounting screws and wall plugs that will anchor this part are not included. To find the right fastening system for your wall, please contact your nearest specialist.

FR. Les meubles doivent être montés conformément aux instructions du fabricant, sinon il peut y avoir un risque de chute ou de basculement. Cela pourrait entraîner des blessures graves.

Les consignes de sécurité doivent être respectées :

- Évitez de placer des objets lourds sur le meuble.

- Empêchez les enfants de s'appuyer ou de grimper sur les tiroirs ou les étagères.

- Placez les objets les plus lourds sur le bas du meuble.

- Fixez le meuble au mur à l'aide. Sinon, il peut y avoir un risque de sécurité en cas de chute ou de basculement, ce qui peut entraîner des blessures graves.

Comme il existe différents matériaux muraux, les vis de montage et les chevilles qui permettront d'ancrer cette pièce ne sont pas fournies. Pour trouver le système de fixation adapté à votre mur, veuillez contacter le spécialiste le plus proche.

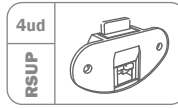
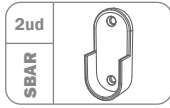
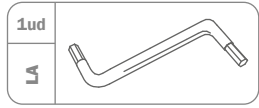
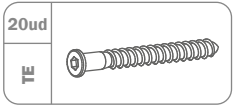
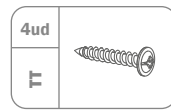
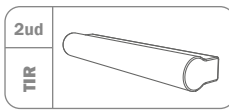
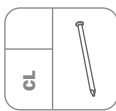
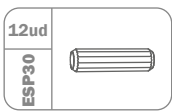

1

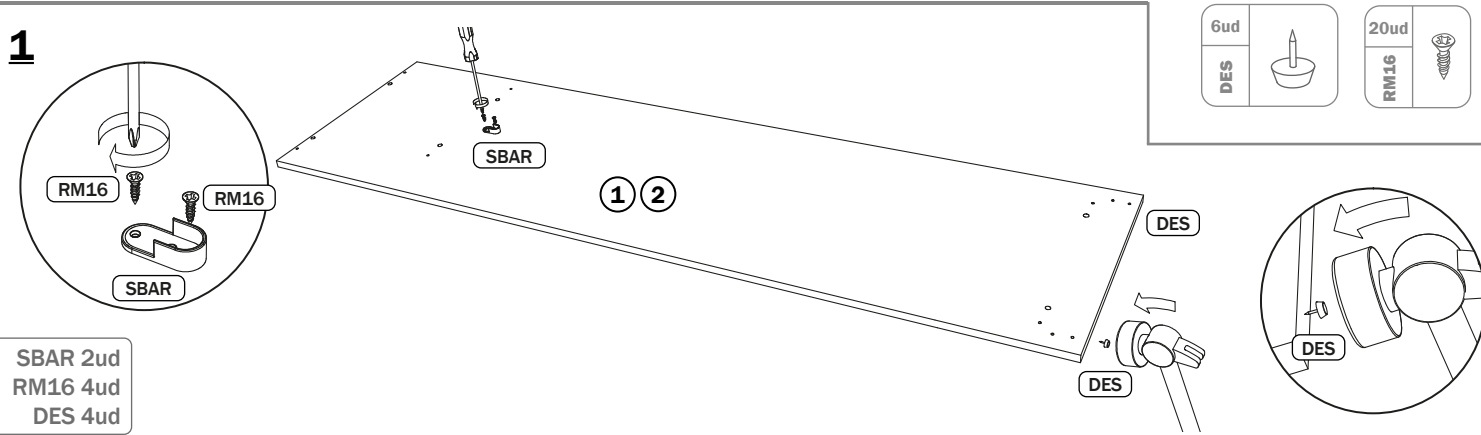

SBAR 2ud
RM16 4ud
DES 4ud

2

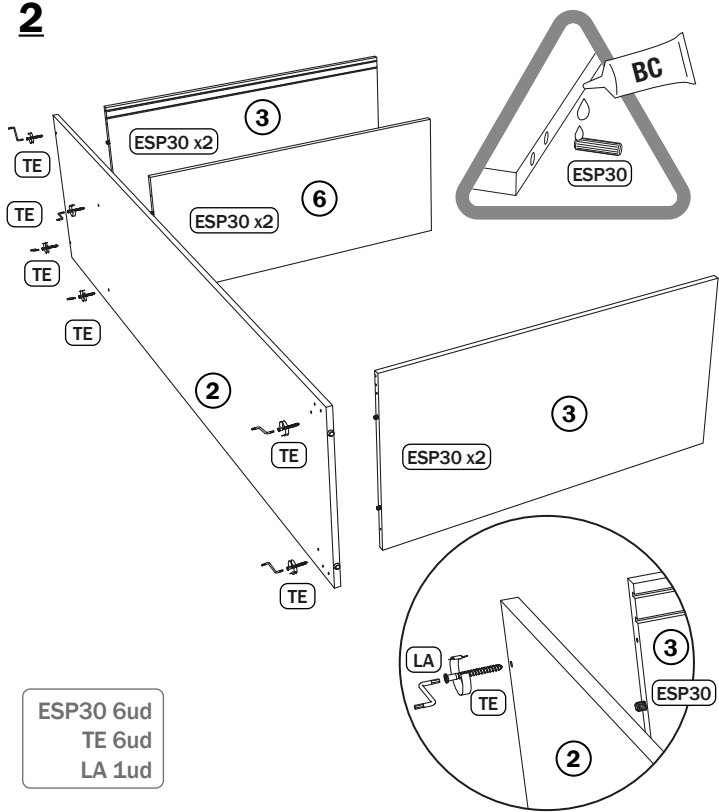

ESP30 6ud
TE 6ud
LA 1ud

3

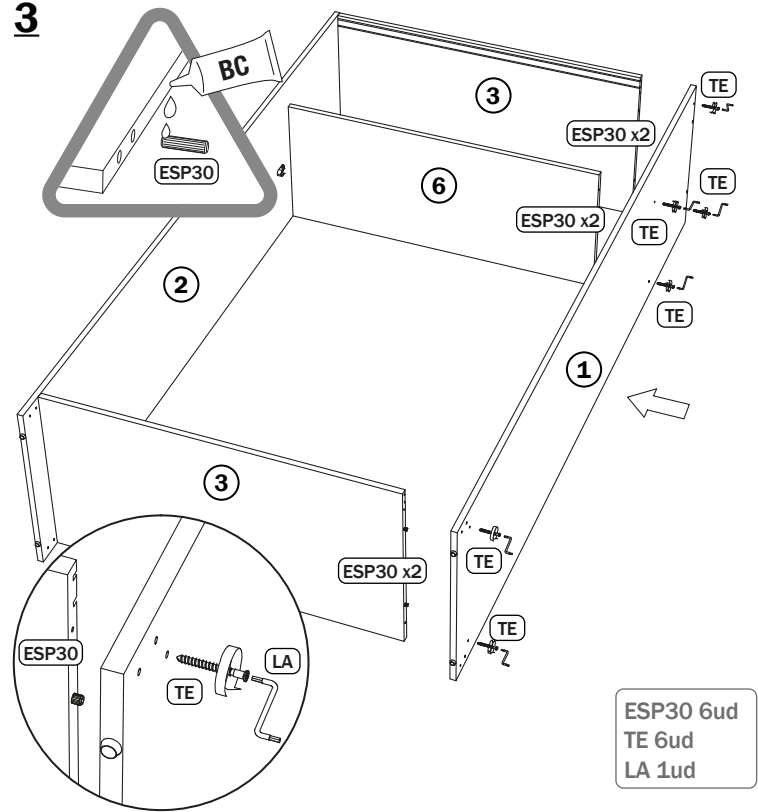

ESP30 6ud
TE 6ud
LA 1ud

4

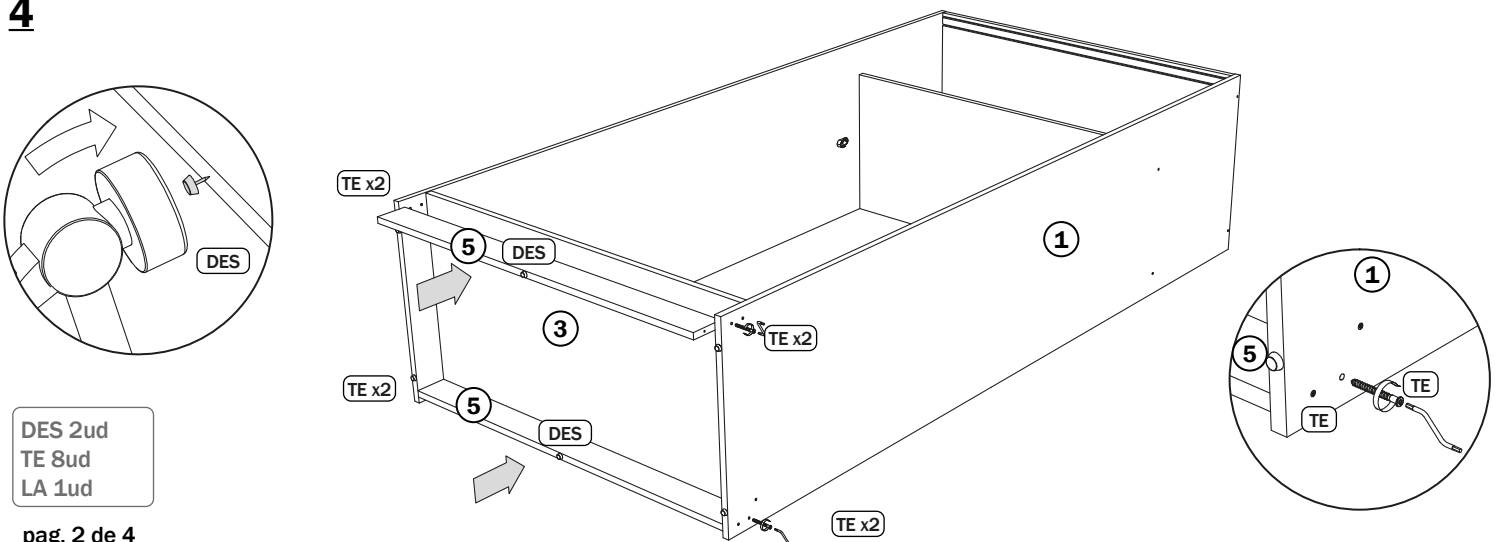

DES 2ud
TE 8ud
LA 1ud

5

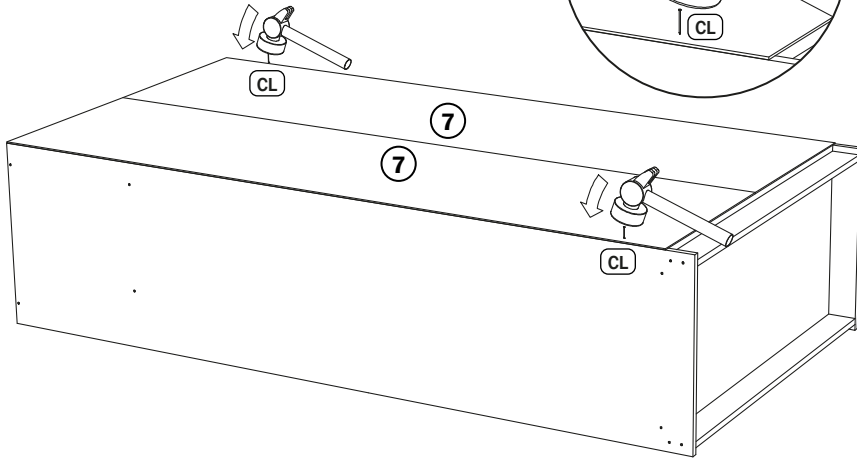
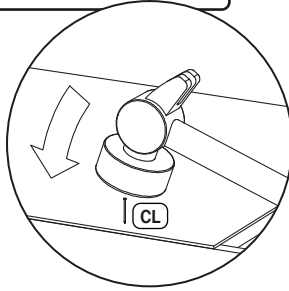
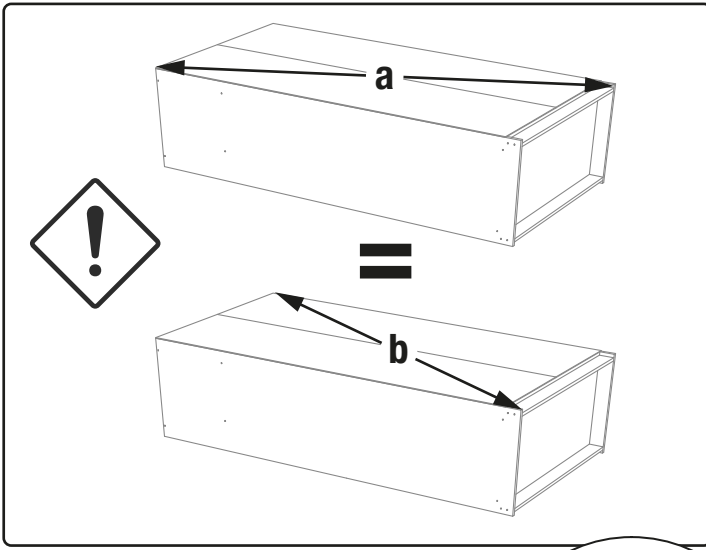

6

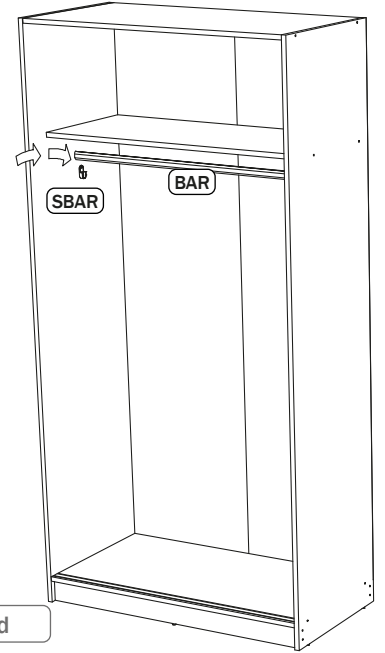
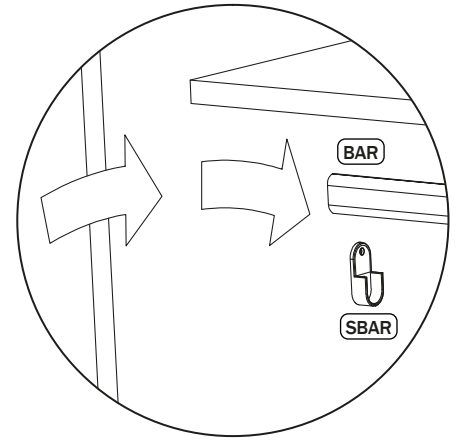

BAR 1ud

7

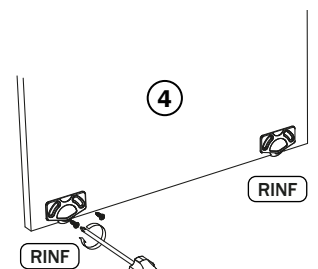
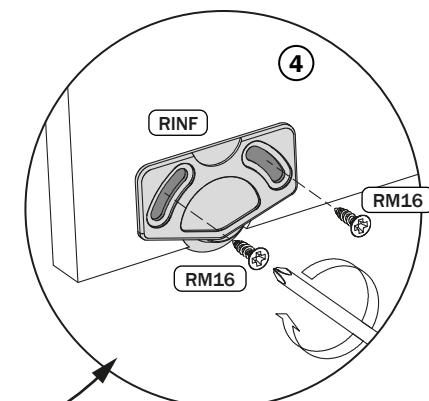
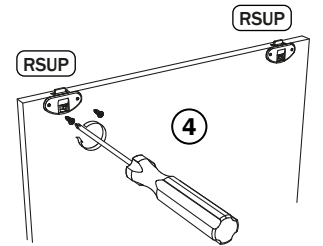
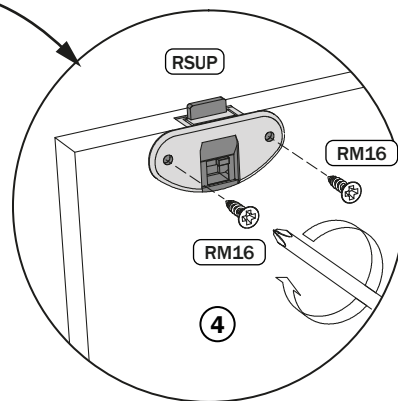
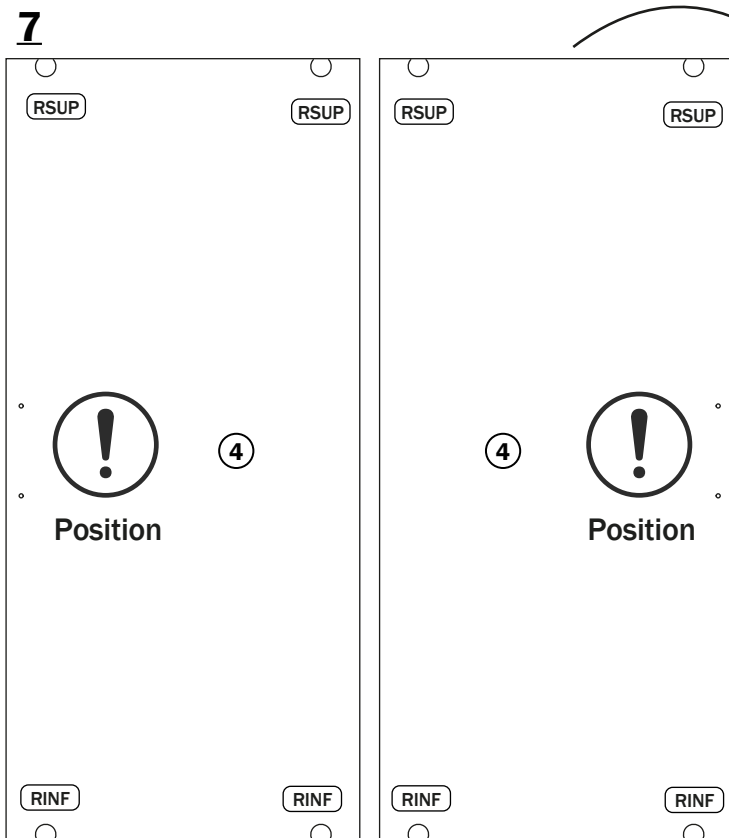

RSUP 4ud

RINF 4ud

RM16 16ud

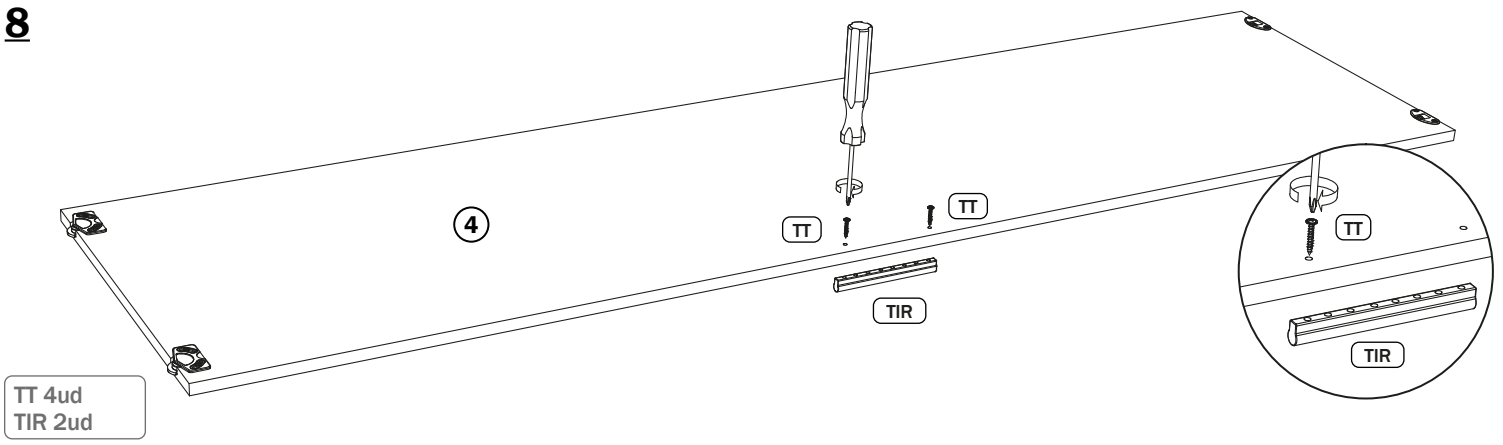

REGULACIÓN DE PUERTAS

REGULAÇÃO DE PORTA - REGULATION DE LA PORTE - DOOR REGULATION

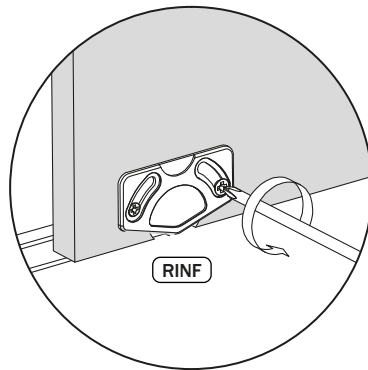
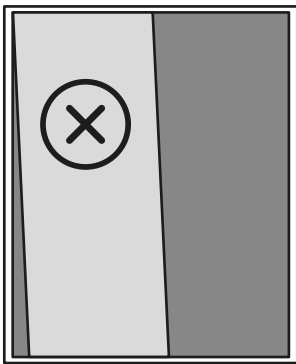

Afloja los tornillos RM16
 Afrouxe os parafusos - Loosen the screws
 Desserrez les vis





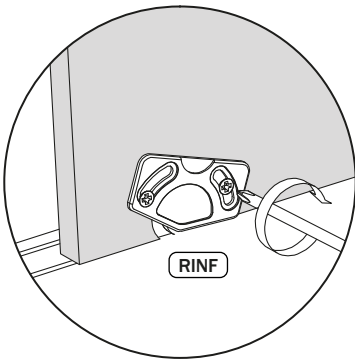
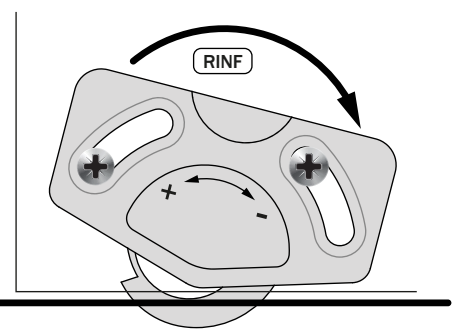
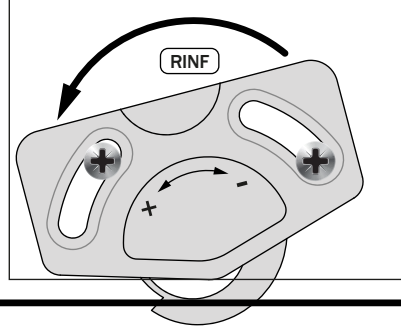
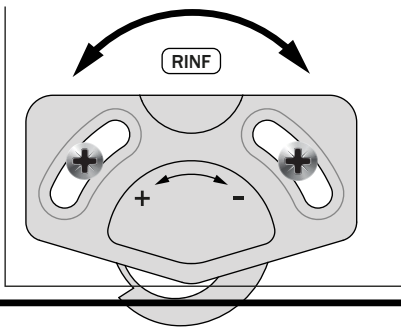

La puerta se levanta
 A porta sobe - The door rises - La porte se lève

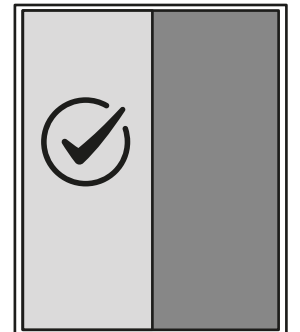
La puerta baja
 A porta desce - The door goes down
 La porte descend



Una vez regulada la puerta apretar los tornillos RM16
 Assim que a porta estiver ajustada, aperte os parafusos.
 Once the door is adjusted, tighten the screws.
 Une fois la porte ajustée, serrez les vis.



<p>ES Conserve ésta etiqueta para cualquier tipo de reclamación</p> <p>PT Guarde este rótulo para qualquer tipo de reclamação</p> <p>EN Keep this label for any requests you may have.</p> <p>FR Conservez cette étiquette pour tout type de réclamation</p>	<table border="1" style="width: 100%; border-collapse: collapse;"> <tr> <td style="width: 30%; text-align: center;">  800000000000 </td> <td style="width: 40%; text-align: center;"> COLOR / ACABADO K-0000 O.F. : 21001111 </td> <td style="width: 30%; text-align: center;">  XXXXXXXXXXXXXXXXXXXXXXXX </td> </tr> </table>	 800000000000	COLOR / ACABADO K-0000 O.F. : 21001111	 XXXXXXXXXXXXXXXXXXXXXXXX
 800000000000	COLOR / ACABADO K-0000 O.F. : 21001111	 XXXXXXXXXXXXXXXXXXXXXXXX		