

TRADE FITTING GUIDE

* Dimensions in mm

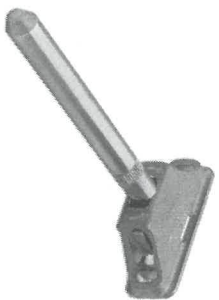

DRILLING PLAN

FOR SHELF 25 ± 30mm THICK

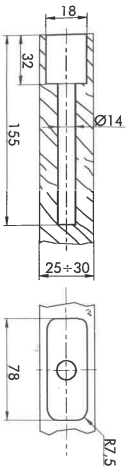

FOR SHELF 30mm THICK AND ABOVE

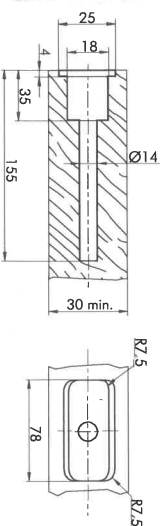

FIXING

TO CEMENT WALL

With rawplugs Ø8 & pan head screws
Ø5x50mm provided

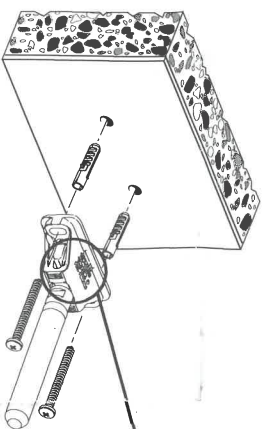

VERY IMPORTANT
Trade has to be installed with the writing "TOP - ALTO" facing upwards.

It is the responsibility of the customer:

- to ensure the wall is of a suitable quality to hold the shelf fixing in place.
- to use the proper hardware fittings according to the construction of the wall.

COMBINATION SHELF LOAD AND SHELF DEPTH (The figures refer to 1 shelf support)

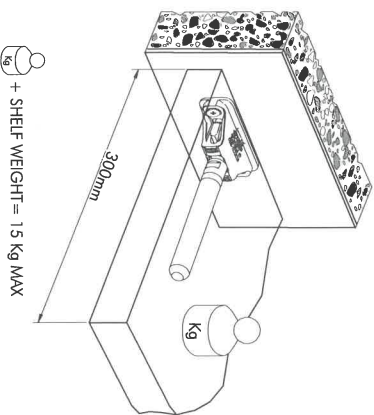
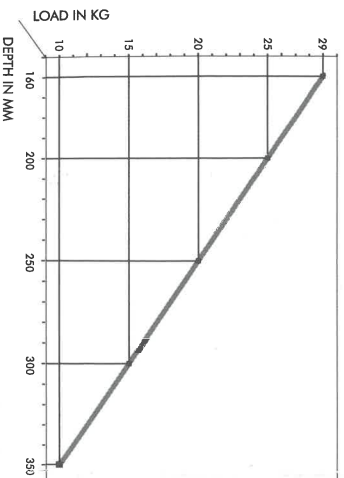

Foglio 103

SHELF INSTALLING AND FULL ADJUSTMENTS

1 VERTICAL ADJUSTMENT

RELEASE THE FIXING SCREWS

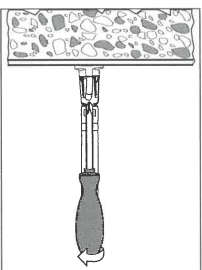

ALIGN BRACKETS VERTICALLY ACCORDINGLY

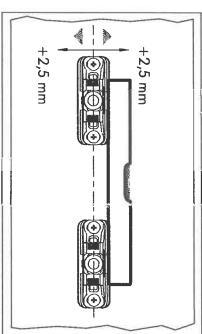

TIGHT THE FIXING SCREWS

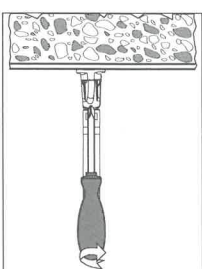

2 SHELF INSERTING AND HORIZONTAL ADJUSTMENT

TILT THE SHELF TO MATCH BOTH SUPPORTING PINS AND SHELF HOUSINGS

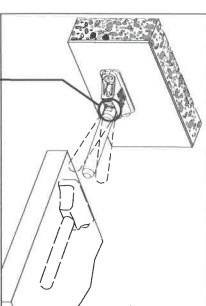

INSERT PARTIALLY THE SHELF

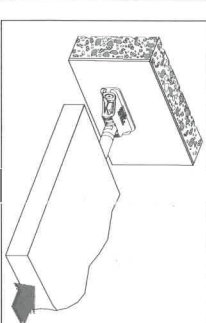

ADJUST THE SHELF HORIZONTALLY ACCORDING TO THE APPLICATION (I.E. MULTI-SHELF COMPOSITION)

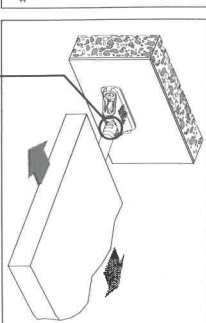

3 INCLINATION ADJUSTMENT

TURN CLOCKWISE THE SUPPORTING PIN WITH A 10 mm OPEN-ENDED WRENCH TO ADJUST THE SHELF ANGLE FRONT TO BACK ACCORDINGLY

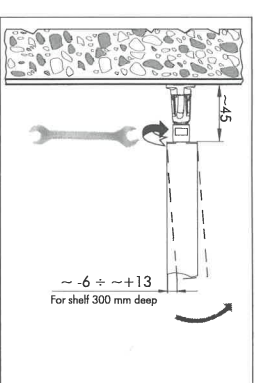

SCREW THE LOCKING BOLT TO BLOCK THE PIN

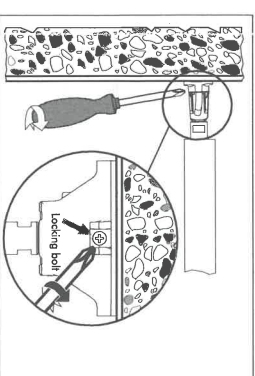

4 SHELF INSERTING

PUSH THE SHELF AGAINST THE WALL UNTIL THE END

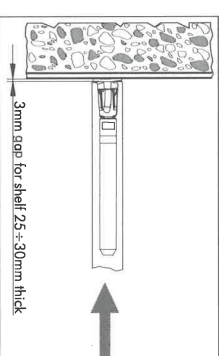

The shelf flushes with the wall if it is thicker than 30mm.

